



SOCIALWORKERS

leaders. advocates. champions.

**National Association of Social Workers
South Carolina Chapter**

**Spring Symposium March 21-23, 2018
*Marriott Hotel, Columbia SC***



Robert “Bob” Blancato is chair of the American Society on Aging and a board member of the National Council on Aging, positions that reflect his 30 years of deep experience in the field of aging and in public service. Professionally, he is president of Matz, Blancato and Associates, a public and government relations firm. Also, he is executive director of the National Association of Nutrition and Aging Services Programs and the national coordinator of the Elder Justice Coalition. He served as volunteer State President of AARP Virginia and as president of the National Committee for the Prevention of Elder Abuse. Blancato spent 17 years on the staff of the U.S. House Select Committee on Aging and has participated in four White House Conferences on Aging, including as the

Executive Director of the 1995 White House Conference on Aging. He currently serves on the national board for AARP.

Randy Thomas is a retired police officer having served for over 25 years in the law enforcement profession. His experience encompasses patrol, investigations, planning and research and over 14 years as a law enforcement trainer and supervisor with the South Carolina Department of Public Safety, Criminal Justice Training Division (Unit Chief, Behavioral Science/ Investigations). He has developed and presented training relating to the investigation of child and elder abuse, domestic violence and juvenile crime. He is certified in Problem Based Learning by the US Department of Justice (COP). He has been the President, National Committee for the Prevention of Elder Abuse and currently serves in an advisory capacity to the United States Department of Justice, Office on Violence Against Women, and The American Bar Association.

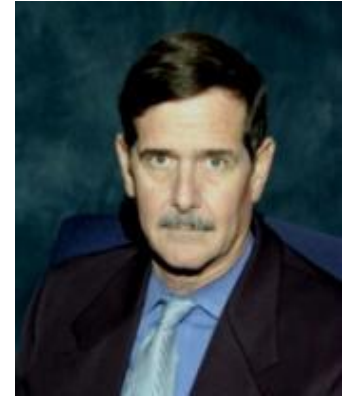

Randy Thomas



Kathryn Wehrmann, PhD, LCSW, National President, NASW received her PhD and MSW from the University of Illinois, Urbana-Champaign. She is currently a faculty member and BSW Program Director at Illinois State University (ISU). She also served in public child welfare and healthcare settings, providing a sound background for being chosen to be a Senior Fulbright Scholar to Romania where she taught and conducted research on child welfare reform. Dr. Wehrmann served at ISU as principal investigator on two child welfare training grants and was recognized for successfully securing approximately \$1M in grants and contracts.

Honored as NASW Lifetime Achievement award recipient at the district level, she served as NASW District Chair, state Conference Chair, Illinois Chapter President, National Board Representative for Region IX, and member of the Executive Committee. She was elected President of NASW in 2017.

Candidates for Governor:

Phil Noble

Catherine Templeton

Yancey McGill

Kevin Bryant

James Smith



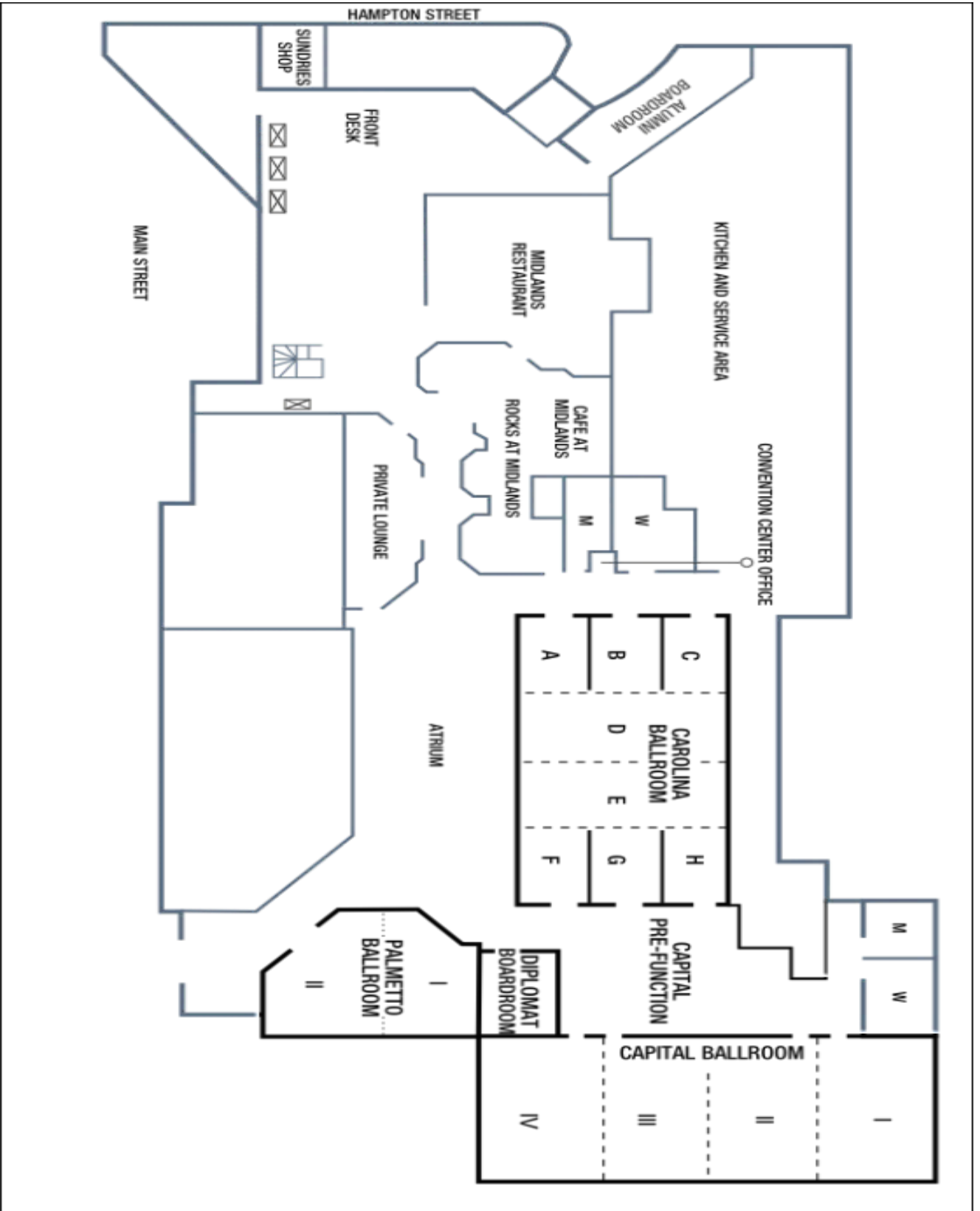

2018 Symposium Workshop Schedule

Wednesday, March 21, 2018

7:30 a.m. Registration and coffee

8:00 a.m. Welcome President, NASW-SC

Opening Plenary:

Bob Blancado,
The National Picture of Elder Justice

9:15a.m.-10:45 a.m. Workshops Session A

A1. **Antwan Aiken, LCSW, MPA, Trauma-Informed Care and the Implications for Service Providers, Staff and Social Work Practice.** Social Workers across practice environments are increasingly being asked to be Trauma-Informed when working with clients that have experienced acute, chronic, complex and historical trauma. Trauma-Informed Care is an organizational structure and treatment framework that requires practitioners to take into consideration a client or family's trauma history when interacting with that system with a goal of not re-traumatizing. Trauma-Informed Care also has an emphasis on safety and support for staff and clients. While embedded in best practices, Trauma-Informed Care can be difficult for agencies to implement and maintain. This workshop will discuss these complexities, both macro and micro, and provide some key strategies—as well as the strengths and barriers of those strategies. Real world examples will be shared, with examples from homelessness and child welfare.

A2. **Kori Bloomquist, PhD, MSW, and Monique Constance-Huggins, PhD, MSW, MPA, Complexities of Well-being: Macro Forces and Children of Color.** Macro forces play an important role in child well-being. Yet, they are not often emphasized in the conceptualization of child neglect. This presentation offers an expanded view of neglect by emphasizing macro influences on child well-being. Presenters discuss strategies to incorporate and attend to these factors in practice and education.

A3. **Margriet de Zeeuw Wright, MSW, PhD, RSW, Rhonda DiNovo, MSW, LMSW, and Patrice Penney, MSW, CSW, Using Case Studies to Discuss Social Work.** Case studies offer a unique way to discuss social work knowledge, skills, values and ethics, cultural competence, organizational and broader social issues. Cases studies can be used as a tool for teaching and learning social work in educational and employment settings. Students, trainers, and supervisors may find this session useful.

A4. **Mary Winstead, ACSW, LISW-CP, CMC and Cynthia Palmore, LMSW Let's Talk: Addressing your own mortality before you can address the needs of your clients. Part 1.** This 3.0-hour presentation is based on a Frontline documentary, titled On Being Mortal. (Aired on PBS in 2015) Dr. Atul Gawande helps viewers to understand death and dying and the role some physicians engage that does the dying process an injustice. Presenters will gingerly broach the topic of death and dying to help participants be in tune to their own reality as we support our clients.

A5. **Monique Constance-Huggins, and Dr. Jessica Yang, Navigating Differences in the Current Sociopolitical Environment: Strategies for Practice.** Social workers are obligated to advance social justice and bridge divides in society. However, they are also impacted by the forces, such as the current sociopolitical climate, that deepen the wedge between diverse groups. This presentation will provide strategies on how to bridge these gaps with colleagues and clients

A6. **Patricia Haversham Brown, K-2 (Spice), Use, Misuse, and Dependence.** The goal is to provide participants with knowledge of synthetic marijuana (K-2), the harm it causes and the signs and symptoms indicating what to look for in abusers. Participants will be provided with the effects on the brain and long and short-term effects. Government intervention will be discussed. Testing for K-2 will also be discussed along with updated data on the substance. Participants will gain an understanding of reasons individuals engage in use despite knowledge of the potential dangers.

10:45 a.m.

Break with Sponsors and Exhibitors

11:00 a.m.-12:30 p.m.

Workshop Sessions B

B1. **Douglas Bates, MSW, Parental Incarceration and the Effects on Children.** America is currently the number one country in the world in terms of incarceration. Nearly 13 million Americans are currently serving a prison sentence and a number of these individuals are parents. The focus of this presentation is an overview of the effects parental incarceration has on children.

B2. **Mary Winstead, ACSW, LISW-CP, CMC and Cynthia Palmore, LMSW Let's Talk: Addressing your own mortality before you can address the needs of your clients. Part 2.**

B3. **Michael Budlong, LCSW, A Practical Approach To Family Assessment and Intervention.** A practical approach to assessing family dynamics and structure will be presented as a conceptual framework for clinical work with families and children. In addition, a model for treatment planning and intervention will be offered, as well as an eight-session model of family therapy. This is a highly stimulating and interactive workshop for those interested in working with families.

B4. **Jim Manning, ACSW, MPA, LISW/AP & CP, DCSW, and Elizabeth Rummel, LISW Candidate, Sex Trafficking – I Realize I Need to Be Better Informed.** Sex trafficking has been around a while, yet many professionals have not had a basic educational workshop on the topic. This “101” workshop will help social workers become better informed by defining and describing human trafficking, address traumatic impacts of this crime and understand the array of services for.

B5. **Susan Parlier, LMSW, ACSW, MAR, and Rhonda DiNovo, MSW, LMSW, Putting the Puzzle Together: Relationships are Basic Needs!** Many say our life task is to find meaning. Based on neuroscience and research, Brene Brown posits we are wired for connection. Interdependence in relationships, not individualism, offers people a sense of meaning, belonging, and empowerment. Facilitators examine practice theories and methods that focus on relationships as a basic human need.

WK B6 **Tanieka Ward and Julie Lundy, NPC, LCC, Hoarding_Hoarding or Clutter: Identifying and Treating the Root of the Problem.** Hoarding Disorder was added to the DSM-5 in 2013 and is said to affect 2 to 5 percent of the population or approximately 6 million Americans. Participants will learn about the disorder itself and ways to assist hoarders and their families find solutions to this complex issue.

12:30 p.m.

**Lunch Plenary: Sara English, LMSW and Heather Bowling, CTT
Who Are You? Choosing Paths to Happiness**



Sara English, LMSW is a doctoral student at the College of Social Work, USC. She is an AGE SW Pre-dissertation fellow and the recipient of the 2017 Outstanding Student Paper Award from the Association of Gerontology in Higher Education. She has researched the protective aspects of non-familial relationships, with a focus on non-related seniors. Her dissertation explores implicit bias, and wellness outcomes in the LTC setting.

Heather Bowling has been a coach and program director for youth and adult aquatics instructional and competitive programs for 15 years, assisting youth and adults in developing resilience and self-awareness, as well as facilitating decision-making. She is a non-traditional second-year student in the MSW program at the University of South Carolina.



2:00 p.m.-3:30p.m.

Workshop Sessions C

C1. Carmen Hampton Julious, LISW-CP&AP, Emotional Intelligence: How to Unleash Your True Genius.

Emotional intelligence reflects self-awareness and adaptability, fosters collaboration among peers, and increases empathy and understanding for consumers. Emotional Intelligence (EI) is more important than IQ in attaining success in personal and professional life. As health and human services providers, we must develop the EI skills required to understand, empathize and negotiate with other people.

C2. Janet Porter, Ph.D, and Teresa Arnold, LMSW, Knowing Your Change Style. This leadership development workshop focuses on improving skills at adapting to and leading change with individuals and groups. Those in attendance will complete the Change Style Indicator (CSI) to learn whether they are a Conservator, Pragmatist or Originator. The CSI framework is a tool for appreciating change styles and provides tips for working effectively with those from all three styles. Those in attendance will learn through reflection, skills building – and humor – how to cope with change more effectively.

C3. Margriet de Zeeuw Wright, MSW, PhD., Melissa Freedman, MSW, and Kim DeCelle, LCSW, Human-Centered Design: Inviting Innovation Into Your Organization. Human-centered design (HCD) is a creative approach for hands-on problem-solving. Human need is at the core of HCD. We start with empathy and end with an innovation tailored to meet needs. In the process we brainstorm, prototype, iterate, and refine. HCD is a dynamic way to address persistent social problems.

C4. Patricia Haversham Brown, LCSW, LCADC, CASAC-G, Housing, Homelessness and the Formerly Incarcerated. The presentation will focus on the stigma attached to the formerly incarcerated individuals coming home from jail/prison and the lack of resources they face in seeking housing and employment. The focus will be on the community's lack of resources to reintegrate this population into mainstream society.

C5. Susan Connolly-Nelson, LISW-CP, CEDS, Eating Disorders 101. Participants will learn the DSM-5 eating disorder diagnoses. We will explore the bio/psycho/social aspects of eating disorders. We will discuss the evidenced base treatments that are indicated for eating disorders. Finally, we will learn the criteria to refer to the appropriate level of care based upon AED criteria.

C6. Shanna A. Jefferson, MSW, CFSW, LCSW, LISW-CP/S, 7 Tools for Success for The Entrepreneurial Social Worker. This presentation will be discussing seven tools for success for social workers to utilize in their entrepreneurial journey. This presentation will take the audience through various tips and levels of success for their social work ideas and businesses. We will be delivering a strong message to the audience about envisioning their success while sharing their passions.

3:30 p.m.

Break with Sponsors and Exhibitors

3:45 p.m. - 5:15 p.m. Workshop Sessions D

D1. Amber Flanigan-Bodrick, LMSW, MPH, CHES, and Sandra Romero, BSW, LMSW, The Role of Social Workers in Reducing Hospital Readmissions. As healthcare continues to change, hospital systems are focusing on ways to reduce hospital readmissions. Social workers play a valuable role on the interdisciplinary care team by helping meet patients' holistic health needs and addressing social determinants that may lead to readmission. This workshop will explore the role of the social worker in this process.

D2. Monique Constance-Huggins, PhD., MSW, MPIA, Ethan Johnstone and Krista Parenti. Oppression in the LGBTQ Community: A Social Justice Concern for All. The LGBTQ community represents one of the most vulnerable populations in the U.S. Yet, their concerns are often overlooked in community needs assessments. This presentation will highlight daunting findings from a needs assessment of the LGBTQ community in Upstate, SC., which reflect a social justice issue for us all.

D3. Susan Toye, LISW, CHP-SW and Mark Higginbotham, LBSW, CHP-SW, The Heart of Hospice. Hospice care is often misunderstood as the end, encompassing the dismal task of sitting with a patient waiting for death. The role of a hospice social worker is a calling to help people and their families live the remaining days to the fullest and accomplish unmet goals at the end of life.

D4. Rhonda DiNovo, MSW, LMSW, and Captain John Norman, Police Social Work: An Emerging Trend. Approximately 40% of calls to the West Columbia Police Department are substance use/mental health related. In efforts to increase use of community support services and to reduce 911 call volume, arrests, and incarceration, the WCPD is utilizing social workers to provide screening, assessment, referrals to treatment, and follow up efforts.

D5. Carmen Jimenez-Pride, MSW, LCSW, LISW-CP, SAP RPTS, RYT, and Jada Alston, Could "13 Reasons Why" be Real: A Discussion on Adolescents, Social Media and Suicide. In the day and age of advanced technology and social media adolescents are exposed to content parents, educators and other supports cannot control. Cyber bullying, peer pressure and risky behaviors are increasing while adolescent's self-esteem and ability to function in social environments are decreasing. This presentation will focus on the impact of social media and social environments on adolescents and how it plays a role in suicide and self-harm behaviors.

D6. Tanya Carter, LMSW, Understanding Dementia

5:15 p.m.

NASW-SC Board Meeting

Thursday, March 22, 2018

8:00 a.m. Registration and Continental Breakfast

8:00 a.m. Plenary: Kathryn Wehrmann, PhD, LMSW, National President, NASW

9:00 a.m. Break with Sponsors and Exhibitors

9:15 a.m.-10:45 a.m. Workshop Sessions E

E1. **Ari Foster, LMSW, and Ellison Kirby, LMSW, Trauma-Informed Responses to #MeToo. Part 1.** Empowered by recent social media movements, the sexual assault survivors you encounter in your profession and in the community, may be more likely to disclose their experiences. This presentation aims to equip attendees with thoughtful and effective responses to #MeToo, while also exploring trauma-informed self-care for providers.

E2. **Brandi Rutan, MSW, LCSW, LISW-CP, What are These Services (HH, PC, & HC) & What Does This Mean For Me As A Practicing SW?** Navigating the system to meet the needs of our patients can become a difficult and overwhelming task as a social worker. We are to be the guru of resources for our patients we serve, however, what do some of the resources mean and how, as a SW, can we tap into these? In this presentation I will discuss each service in detail, the pro's and con's of each of these services, and lastly what a social worker's role may look like working within these systems.

E3. **Terry Wolfer, MSW, PhD., and Janessa Steele, Individual Development Accounts in Community Settings.** Individual Development Accounts are matched savings accounts offered through local institutions that enable participants to save for an asset such as a home or education. This session will introduce the concept, explore ways it can be applied in community settings, and identify benefits of participation in an IDA program.

E4. **Corey Beauford, SW Licensure Exam Prep Part 1.** Corey Beauford, MSW, LICSW. This presentation will share information about the revised social work licensing examination. We will juxtapose the content outlines of the old exam with the new exam. Participants will review subject matter covered on the ASWB exams as well as sample exam questions. Strategies useful for success on the exam will also be shared. Part One of this workshop will cover information relevant to the Bachelors level exam.

E5. **Nikki R. Wooten, PhD., LISC-CP and Emily Werdowatz, B.A., Risky Drinking and Tobacco Use in South Carolina Veterans.** Using data from the 2014 South Carolina Behavioral Risk Factor Surveillance System survey, this presentation reviews prevalence rates of risky drinking and tobacco use among South Carolina veterans. A case presentation will be presented, and implications for alcohol problem prevention, tobacco cessation, and military social work practice will be discussed.

E6. **Daniel Freedman, PhD., MSW, LISW-CP, Mary-Margaret Wilder, and William Benitez, AA, Advocating for Criminal Justice Reform in the 21st Century.** Over the past two decades, criminal justice practices in the United States have responded to dynamic legal, policy, and operational changes. Despite these shifts, many scholars and practitioners continue to note the institutional discrimination found in the criminal justice system. This presentation will highlight advocacy strategies for addressing these social injustices.

E7. Sara English, LMSW, Andrew Flaherty, LCSW, and Heather Boiling, Gas-lit! Adult Bullying in Places of Work and Learning. Many adults experience bullying, incivility, and violence in the workplace and in higher education. This panel will examine current literature regarding adult on adult bullying, ethical a recent study of bullying among doctoral students, and the role social workers in the creation of a culture of caring.

10:45 a.m. Break with Sponsors and Exhibitors

11:00 a.m.-12:30 p.m. Workshops Sessions F

F1. Ari Foster, LMSW, and Ellison Kirby, LMSW, Trauma-Informed Responses to #MeToo. Part 2

F2. Tracey Tucker, MSW, JD, and Jeree Thomas, Esq., Raise the Age: Coalition Building to Keep Children out of Adult Courts, Jails, and Prisons. In South Carolina, all 17-year-olds are prosecuted as adults in the criminal justice system. This workshop will detail recent legislative and campaign coalition efforts to keep youth under 18 out of adult courts, with an emphasize on the role of social workers in statewide youth justice reform.

F3. Leslie Porell, LMSW, What Every Social Worker Needs to Know About Palliative Care. The field of Palliative Care is exploding due to an aging population and an increase in lifespan for those living with serious illness. Social workers will play a huge role in this field. What exactly is it? What do you need to know?

F4. Mariah Moran, LCSW, MSW, Melissa C. Reitmeier, PhD., LMSW, MSW, Aidyn L. Iachini, PhD., LSW, MSW, and Andrew Flaherty, MSW, PhD Candidate, Making Interventions Work in the Real World. This presentation explores the experiences of social work practitioners with translating an evidence-based intervention into practice. Specifically, data will be presented from social workers recently trained in SBIRT to identify facilitators and challenges to implementation. Discussion will focus on factors that impact implementation of this and other evidence-based practices.

F5. Kelly Howard, LMSW and Sommer Cagle, Fostering Successful Placements: Factors Considered When Placing Children. The author discusses the context in which children in foster care are placed. Based on a review of literature and ethnographic interviews conducted of people within the field, the author suggests ways the system can better serve children in foster care through temporary placement options individualized for each child.

F6. Corey Beauford, SW Licensure Exam Prep Part 2

F7. Patricia Haversham-Brown, LCSW, LCADC, CASAC-G, Mental Health First Aid. A beginner-level training to introduce mental health and mental illness, providing an understanding of what impacts our mental health. We will openly discuss mental health, ways to reduce the stigmatization and relate mental illness to any other illness we face today.

12:30 p.m. LUNCH ON YOUR OWN: Check out our wonderful downtown restaurants!

2:00 p.m.-3:30 p.m. Workshop Sessions G

G1. Lauren Taylor Wilkie, LISW-AP, LMSW, America: The Newest Third World Nation. The Housing Crisis! Cultural competency training on Poverty leading to Homelessness. This workshop will engage attendees in a discussion of statistics that explain what trends in society and what social systems are causing poverty leading to homelessness. We

will look at barriers to reducing homelessness and best practice solutions. We will discuss community level change and resources to combat homelessness.

G2. Brandi Rutan, MSW, LCSW, LISW-CP, Geriatric Mental Health, What SW's Need to Know. It is estimated that 20% of people age 55 years or older experience some type of mental health concern. The most common conditions include anxiety, severe cognitive impairment, and mood disorders (such as depression or bipolar disorder). The importance of social and emotional supports and how this interfaces with geriatric mental health diagnosis. Lastly, the importance of geriatric counseling to meet the needs of this growing concern.

G3. Brooke Chehoski, MSW, My So-Called Life: Behind the Scenes of a PhD Program. If you've ever thought about applying to USC's social work PhD program, this session is for you! Learn about the application process, how it compares to an MSW program, the joys and challenges of independent scholarship, subsisting on coffee and vending machine snacks, and job opportunities for those who survive!

G4. Rebecca Christopher, MSW, LMSW, Andrew Flaherty, MSW PhD Candidate, Cara Bibeault, BSW, Julia Toumey, B.A., and John Martin, Rural Matters: Appreciating and Investing in the Rural Health Workforce. This presentation will provide necessary education and best practices related to interprofessional health services to enhance service delivery in rural settings. The presentation will also explore strategies to improve retention and capacity building in rural settings in efforts to attain, sustain and retain our healthcare workforce in rural South Carolina.

G5. Melissa Reitmeier, PhD., LMSW, MSW, and Doward Terrell Hunter, Mosquito Net Usage Rates, In Prevention of Malaria Transmission. Studies have found bed net distribution less effective in reducing Malaria prevalence. Furthermore, low utilization of bed nets once issued. This study aims to assess insecticide nets ownership and utilization, and examine possible reasons related to its lack of use through primary and secondary data research.

G6. Nicole M. Cavanagh, PhD., LISW-AP/CPs, Managing the End of Life Care. The growing need for information, tools, and analysis on topics such as palliative care and advance care planning is essential in client-focused care. This session provides social workers, and other health professionals, ways to enhance their skills to maximize their effectiveness to address the critical palliative care needs facing patients and their families.

3:30 p.m. Break with Sponsors and Exhibitors

3:45 p.m.-5:15 p.m. Afternoon Plenary- Climate Change: Implications for Social Work Panelists:



Marjorie Hammock, LISW-CP, moderator



Meredith C. F. Powers, PhD, MSW, Professor at UNC Greensboro



Greg Carbone, PhD, Professor of Geography, USC



Eric Brenner, PhD, Associate Professor, USC, and Medical Epidemiologist

5:30 p.m. Social Hour/ PARTY to Celebrate Social Work Month! Marriott Hotel, Suite 1415
Sponsored by the University of South Carolina College of Social Work

Friday, March 23, 2018

8:00 Forum with Candidates for Governor

Moderators: Macie Smith, PhD, Krystal Reid Heath, LMSW, and Teresa Arnold, LMSW



Phil Noble



Catherine Templeton



Yancey McGill



Kevin Bryant



James Smith

9:15 a.m. Break with Sponsors and Exhibitors

9:30 a.m.-11:00 a.m. Workshop Sessions H

H1. Antoinette Coleman Sanders, LMSW, When Faith and Death Collide: Is It Ok To Die? Faith/Religion can have a positive or negative impact upon one's dying and grieving process. Struggles with the spiritual aspects of imminent death and grief can prevent one from making critical end of life decisions. Journey with me as we explore techniques and overcome barriers when faith and death collide.

H2. Brenda J. Amedee, LMSW, Suzanne Sutphin, PhD., Traci Gilden, Describing an Inter-rater Reliability Process in Child Welfare. The presentation will focus on Inter-rater Reliability (IRR) as a part of the Quality Assurance (QA) Review Process in Child Welfare. We will discuss the importance of conducting IRR in evaluating the reliability of the QA Reviewers and present findings and benefits based on the completion of three rounds IRR reviews.

H3. Elena Bell, LISW-CP, LMFT and Sallie Campbell, LISW-CP, LMFT, DCSW, Navigating Choices for Successful Retirement. At what point do we consider retirement planning. What issues do social workers face as they retire? What decisions go into this transition and lifestyle choice. How do we successfully plan for a new beginning, embracing our professional values as we build new identities? A panel of social workers will discuss how they have successfully managed this transition.

H4. Elizabeth Ann Surratt, LISW-CP, Traumatic Bereavement. The goal of cognitive therapy for bereavement will be discussed. Myths of mourning will be identified as well as stuck points the therapist may encounter while working with bereavement issues. Following a role play between therapist and patient, participants will complete an ABC worksheet related to trauma.

H5. LeAnn Gardner, LISW-CP, MDiv, Wraparound Sexuality Education: Empowering Clinicians to Address Issues of Sex, Safety and Empowerment Part 1. Have you ever been asked questions about how to address boundaries and consent with children? How to talk to kids about pornography? How to begin conversations about puberty and body safety? What is typical sex play versus problematic sexual behaviors? If so, LeAnn will provide ways to help you equip caregivers to have these daunting conversations and why they are crucial conversations to have. She will provide an extensive resource list as well as give the latest research in why wraparound sexuality education is essential in keeping our kids safe.

H6. Randy Thomas, MA, Teresa Arnold, Financial Exploitation of the Elderly and Other Vulnerable Adults This session will focus on the complex issues associated with the financial exploitation of the elderly and other vulnerable adults. It will address the prevalence, relationship to other forms of abuse and the key factors that allow perpetrators to gain access to the assets of the victim. Specific attention will be paid to the SC Omnibus Adult Protection Act as it relates to this subject.

11:00 a.m. Break with Sponsors and Exhibitors

11:15 a.m.-12:45 p.m. Workshop Sessions I

I1. LeAnn Gardner, LISW-CP, MDiv, Wraparound Sexuality Education: Empowering Clinicians to Address Issues of Sex, Safety and Empowerment Part 2.

I2. Lorraine Cragan-Sullivan, LMSW, MA, NCC, and Taylor Bagwell, Developmental Promotion Continuum: Monitoring-Screening- Linkage to Service. Through lecture, dialogue, and interactive exercises; participants will be immersed in the world of developmental monitoring, screening, and linkage to services. Case studies will be utilized to highlight the developmental promotion continuum. Resources for early childhood development and early intervention in the state will also be discussed.

I3. Macie Smith Perry, PhD., LMSW, and Marisette Hasan, BSN, RN, Isn't It Time We Talk: Laying the Groundwork for Effective Advanced Care Planning Conversations. Advance care planning is one of those topics that embodies the art of "addressing the elephant in the room." Facilitating advanced care planning conversations is not for the faint at heart but requires skill and sensitivity to facilitate goals of care discussions with patients and their families during care transitions. This workshop is an interactive session will provide practical tools to assist health care professionals in their day to day work facilitating advanced care planning discussions in diverse cultural settings.

I4. Suzanne Sutphin, PhD., and Malik Whitaker, J.D., Implementing a Child Welfare Program Improvement Plan in South Carolina. The presentation will describe the development and implementation of a Program Improvement Plan as part of the Child and Family Services Review. We will discuss the impact of the plan on improving safety, permanency, and well-being for children and families and the importance of the involvement of community partners.

I5. Mary How, LISW-CP, Mindfulness In Practice. How being mindful in our own lives can help us practitioners. This workshop will focus on practical ways to implement mindfulness in your daily life which, in turn, will improve your practice. Through creative processes like art, we will explore how to improve our personal use of mindfulness. In order to teach it, we have to practice it!

16. **Jeanne Cook, PhD, Sammy Caldwell, LMSW, and Carla Damron, LISW-CP, Changes to the Code of Ethics.** The NASW Code of Ethics continues to be the most accepted standard for social work ethical practice worldwide. With emergent technological advances over the last two decades, the profession could not ignore the necessity for more clarity around the complex ethical issues that arise with the use of various forms of technology. The NASW Code of Ethics contains 19 new standards and revisions to several longstanding standards developed to address ethical considerations when using technology.

12:45-1:15 p.m. Lunch Session: Recognizing Excellence in our Field: Social Work Awards

1:15 p.m. Closing Plenary: A Trip Through the Ages: Addressing Elder Abuse in South Carolina, Randy Thomas, MA, Teresa Arnold, MSW moderator

This session will take a trip through the efforts of South Carolina to address this issue. It will explore how the Omnibus Adult Protection Act impacts everyone who has a role to play in this issue and will include the concerns of social workers, the justice system, the political environment and the public. A specific abuse case in South Carolina will be used to illustrate the complexity of this subject. Attention will be paid to what the future may hold for this important issue and a possible path to provide a safe environment as we age.

2:30 p.m. Conference Adjourns: See you next year!

NASW-SC Says Thank You to our amazing, hardworking Symposium Committee:
Staff: Juliana Palyok and Carla Damron

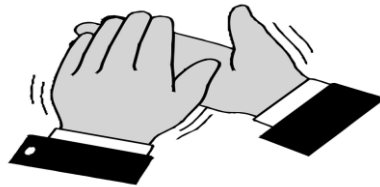

June Westerlund, Chair
Shirley Furtick
George Mavroftas
Victoria
Brenda Hyleman
Amy Helms

Deborah Duvall
Gary Tyson
Marjorie Hammock
Julia Grimm
Victoria Wilson

We Love our Sponsors and Exhibitors!

Platinum Level and Event Sponsor:

Columbia Regional Center
San Marco Treatment Center
Premier Counseling

Bronze Level Sponsors:

Three Rivers Midlands
Caughman-Harman Funeral Home
Roger C Peace Rehabilitation Hospital
Carolina Behavioral Therapy
Palmetto Summerville Behavioral Health
Palmetto Lowcountry Behavioral Health

Exhibitors:

Lighthouse Behavioral Health Hospital
Carolina Center for Behavioral Health
Home Instead Senior Care
All About Seniors
All Seasons Hospice
Three Rivers Behavioral Health
Amedisys Home Health
Springbrook Behavioral Health

Non-Profit Level:

National Multiple Sclerosis Society
Winthrop University
The Nurturing Center
MedScope PERS
The Heritage at Lowman
Teach Boys and Girls Success
Rest Assured Hospice
SC Youth Advocate Program
Johnson C Smith University
SC Thrive
Saint Leo University
SC Dept of Alcohol and other Drug Abuse Services



Job Posting:

In search of a social worker (LISW-CP) to work as an independent contractor for an established, well respected, church-affiliated practice in the Lexington/Richland County area. This is an Monday through Friday, full or part time position; no evenings or weekends. Our practice is on most insurance and EAP panels and would prefer a current Medicare provider. We have an excellent administrative support staff and are looking for a team player to join us. For consideration, please email a cover letter and CV to CounselorApplicationReply@gmail.com.

**Enrich Your Career
Make Progress on Advanced Licensure**

**Clinical Supervision
Groups on Saturdays
Individual Supervision**

Skills and Support for Social Workers

Offered By
Michelle Trask, LISW-CP
In Columbia

michelle.trask@gmail.com



Premier

Counseling



san marcos treatment center

(p) 800.848.9090 (f) 800.205.9739



THREE RIVERS

MIDLANDS



GREENVILLE
HEALTH SYSTEM

Roger C. Peace
Rehabilitation Hospital

Carolina
BEHAVIORAL THERAPY



PALMETTO

Summerville

BEHAVIORAL HEALTH

Caughman Harman Funeral Homes

Lexington * Chapin * West Columbia

803-359-6118

Southland Memorial Gardens

Elmwood Funeral Home & Cemetery

Dignity[®]
MEMORIAL

∞ LIFE WELL CELEBRATED[®] ∞

 **CORRECT CARE**
RECOVERY SOLUTIONS

COLUMBIA REGIONAL CARE CENTER

Correct Care Recovery Solutions has more than 15 years' experience operating state psychiatric hospitals treating forensic and civil populations, including the current management of six (6) Adult Residential Treatment Centers.

Correct Care hires **Master's** level Social Workers to work at **Columbia Regional Care Center (CRCC)**. CRCC provides inpatient forensic and mental health treatment and evaluation services to include comprehensive assessments, evaluation and treatment of psychiatric disorders for individuals involved with the criminal court system for a wide range of mental illnesses and conditions. Join our team of dedicated professionals and practice in a facility that allows you to have a stable work schedule and preserve a reasonable lifestyle. Our company offers competitive compensation and benefits including medical, dental, vision, 401(k) and more. For further information please contact Human Resources at 803-753-0752.

www.correctcarers.com

2018 NASW-SC SPRING SYMPOSIUM SCHEDULE AT A GLANCE

Wednesday, March 20

P1 8:00a.m.-9:00a.m. Opening Plenary: Bob Blancado, Picture of Elder Justice

9:15a.m.-10:45a.m. Workshops A

- _____ A1. Antwan Aiken, Trauma-informed Care and the Implications for Service Providers, Staff and Social Work Practice
- _____ A2. Jim Manning, Sex Trafficking - I Realize I Need To Be Better Informed
- _____ A3. Margriet de Zeeuw Wright, Using Case Studies to Discuss Social Work
- _____ A4. Mary Winstead, Let's Talk: Addressing your own mortality before you can address the needs of your clients - Part I
- _____ A5. Monique Constance-Huggins, Navigating Differences in the Current Sociopolitical Environment: Strategies for Practice
- _____ A6. Patricia Haversham Brown, K-2 (Spice), Use, Misuse & Dependence

11:00a.m.-12:30p.m. Workshops B

- _____ B1. Douglas Bates, Parental Incarceration and the Effects on Children
- _____ B2. Mary Winstead, Let's Talk: Addressing your own mortality before you can address the needs of your clients - Part 2
- _____ B3. Michael Budlong, A Practical Approach to Family Assessment & Intervention
- _____ B4. Kori Bloomquist Complexities of Well-being: Macro Forces and Children of Color
- _____ B5. Susan Parlier, Putting the puzzle together: Relationships are basic needs!
- _____ B6. Tanieka Ward, Hoarding???????

P2 12:30p.m.-2:00pm, Lunch Plenary: Sara English, Who Are You? Choosing Paths to Happiness

2:00a.m.-3:30p.m. Workshops C

- _____ C1. Carmen Hampton Julious, Emotional Intelligence: How to Unleash Your True Genius
- _____ C2. Janet Porter, Decision Making: A Self-Assessment
- _____ C3. Margriet de Zeeuw Wright, Human-Centered Design: Inviting innovation into your organization
- _____ C4. Patricia Haversham Brown, Housing, Homelessness & the Formerly Incarcerated
- _____ C5. Susan Connolly-Nelson, Eating Disorders
- _____ C6. Shanna Jefferson, 7 Tools for Success for the Entrepreneurial Social Worker

3:45p.m.-5:15p.m. Workshop D

- _____ D1. Amber Flanigan-Bodrick, The Role of Social Workers in Reducing Hospital Readmissions
- _____ D2. Monique Constance-Huggins, Oppression in the LGBTQ Community: A Social Justice Concern for All
- _____ D3. Susan Toye, The Heart of Hospice
- _____ D4. Rhonda DiNovo, Police Social Work: An Emerging Trend
- _____ D5. Carmen Jimenez-Pride, Could "13 Reasons Why" be Real: A discussion on Adolescents, Social Media and Suicide
- _____ D6. Tanya Carter, Dementia

Thursday, March 21

P3 8:00a.m.-9:00a.m. Plenary: Elected Officials/Political Candidates Panel and Recognizing Excellence in our Field: Social Work

9:15a.m.-10:45a.m. Workshops E

- _____ E1. Ari Foster, Trauma-Informed Responses to #MeToo Part 1
- _____ E2. Brandi Rutan, What are these services (HH, PC, & HC) & what does this mean for me as a practicing SW?
- _____ E3. Terry Wolfer, Individual Development Accounts in Community Settings

_____ E4. Corey Beauford, SW Licensure Exam Prep Part 1

_____ E5. Nikki Wooten, Risky Drinking and tobacco Use in SC Veterans

_____ E6. Rebecca Christopher, Rural Matters: Appreciating and Investing in the Rural Health Workforce

_____ E7. Sara English, Gas-lit! Adult Bulling in Places of Work and Learning

11:00a.m.-12:30p.m. Workshops F

- _____ F1. Ari Foster, Trauma-Informed Responses to #MeToo Part2
- _____ F2. Jeree Thomas, Raise the Age
- _____ F3. Leslie Porell, What Every Social Worker Needs to Know About Palliative Care
- _____ F4. Mariah Moran, Making Interventions Work in the Real World
- _____ F5. Kelly Howard, Fostering Successful Placements: Factors Considered
- _____ F6. Corey Beauford, SW Licensure Exam Prep Part 2
- _____ F7. Patricia Haversham Brown, Mental Health First Aid

2:00p.m.-3:30p.m. Workshops G

- _____ G1. Lauren Taylor Wilkie, America: The Newest Third World Nation -
- _____ G2. Brandi Rutan, Geriatric Mental Health
- _____ G3. Brooke Chehoski, My So-Called Life: Behind the Scenes of a PhD Program Panel Discussion
- _____ G4. Daniel Freedman, Advocating for Criminal Justice Reform in the 21st Century
- _____ G5. Melissa Reitmeier, Mosquito Net Usage rates, in prevention of Malaria transmission
- _____ G6. Nicole Cavanagh, Managing the End of Life Care

P4 3:45p.m.-5:15p.m. Afternoon

Plenary: Environmental Panel

Friday, March 22

P5 8:00a.m-9:00a.m. Breakfast

Plenary: Ethics Panel

9:15a.m.-10:45a.m. Workshops H

- _____ H1. Antoinette Coleman Sanders, When Faith and Death Collide: Is It Ok To Die?
- _____ H2. Brenda Amedee, Describing an Inter-rater Reliability Process in Child Welfare
- _____ H3. Elena Bell, Navigating Choices for Successful Retirement
- _____ H4. Elizabeth Ann Surratt, Traumatic Bereavement
- _____ H5. LeAnn Gardner, Wraparound Sexuality Education: Empowering Clinicians to Address Issues of Sex, Safety & Empowerment - Part 1
- _____ H6. Randy Thomas, Financial Exploitation Elderly

11:00a.m.-12:30a.m. Workshops I

- _____ I1. LeAnn Gardner, Wraparound Sexuality Education: Empowering Clinicians to Address Issues of Sex, Safety & Empowerment - Part 2
- _____ I2. Lorraine Cragan-Sullivan, Developmental Promotion Continuum: Monitoring-Screening-Linkage to Service
- _____ I3. Macie Smith Perry, Isn't It Time We Talk: Laying the Groundwork for Effective Advanced Care Planning Conversations
- _____ I4. Suzanne Sutphin, Implementing a Child Welfare Program Improvement Plan in SC
- _____ I5. Mary How, Mindfulness?????

12:30p.m. Lunch & Awards

P6 1:15 p.m. Closing Plenary: Randy Thomas, A Trip Through the Ages: Addressing Elder Abuse